

CERTIFICATE OF OWNERSHIP AND DEDICATION

I HEREBY CERTIFY THAT I AM (WE ARE) THE OWNER(S) OF THE PROPERTY SHOWN AND DESCRIBED HEREON.

DATE SIGNED _____ OWNER'S SIGNATURE _____

CERTIFICATE OF ACCURACY AND PRECISION

I HEREBY CERTIFY THAT THE PLAN SHOWN AND DESCRIBED HEREON IS A TRUE AND CORRECT SURVEY TO THE LEVEL OF ACCURACY REQUIRED BY THE STATE OF TENNESSEE. I FURTHER CERTIFY THAT THE DEGREE OF PRECISION (LINEAR AND ANGULAR) MEETS THE STANDARDS REQUIRED OF AN URBAN AND SUBDIVISION SURVEY AS ESTABLISHED BY THE TENNESSEE BOARD OF EXAMINERS FOR LAND SURVEYORS.

DATE SIGNED _____ REGISTERED LAND SURVEYOR _____

TENNESSEE NUMBER: _____

GUS MULLER
BOOK 11
PAGE 573

LINE	BEARING	DISTANCE
L1	S 27°51'28" E	288.51'
L2	S 05°59'36" E	58.02'
L3	S 05°59'36" E	59.55'
L4	S 14°05'17" W	77.75'
L5	S 60°06'02" W	29.48'
L6	S 37°54'46" W	40.73'
L7	S 07°17'07" W	40.60'
L8	S 47°44'56" W	32.16'
L9	S 57°24'54" W	17.67'
L10	S 45°13'51" W	86.01'
L11	S 13°28'51" W	152.58'
L12	S 09°04'06" E	130.14'
L13	S 09°04'06" E	111.58'
L14	S 08°56'47" E	118.48'
L15	S 36°47'34" W	78.11'
L16	S 65°26'02" W	99.48'
L17	S 19°37'57" W	58.42'
L18	S 13°36'33" E	35.90'
L19	S 25°23'45" W	118.53'
L20	S 20°12'16" E	108.68'
L21	S 00°32'31" W	57.49'
L22	S 73°30'13" W	41.87'
L23	S 05°28'10" E	95.30'
L24	S 09°32'28" W	84.46'
L25	S 09°32'28" W	276.44'
L26	N 03°33'05" E	126.95'
L27	N 04°17'00" E	206.51'
L28	N 04°19'08" E	221.76'
L29	N 45°44'28" W	107.85'
L30	N 41°14'26" W	38.16'
L31	N 32°37'28" W	56.59'
L32	S 09°43'55" E	188.10'
L33	S 08°37'10" W	152.20'
L34	N 08°37'10" E	144.12'
L35	N 09°43'55" W	260.17'
L36	N 16°56'05" W	177.03'
L37	N 00°00'00" W	252.74'
L38	N 23°58'19" W	284.08'
L39	N 10°43'04" W	139.45'
L40	N 10°43'04" W	136.27'
L41	N 15°18'06" E	279.46'
L42	N 88°19'52" W	576.19'
L43	N 88°19'52" W	37.34'
L44	N 80°11'03" W	189.02'
L45	S 27°17'15" W	147.07'
L46	S 28°39'31" W	251.38'
L47	S 47°30'06" W	46.45'
L48	S 26°17'14" W	113.94'
L49	S 52°32'20" W	209.68'
L50	S 52°32'20" W	120.68'
L51	S 49°17'19" W	250.77'
L52	S 19°47'58" W	144.20'
L53	S 19°47'58" W	41.12'

L54	S 15°51'50" W	211.27'
L55	S 28°17'48" W	110.67'
L56	S 28°17'48" W	140.01'
L57	S 69°13'44" W	138.69'
L58	N 66°36'13" W	168.78'
L59	N 75°11'53" W	144.74'
L60	S 37°54'46" W	148.50'
L61	S 66°36'13" E	152.25'
L62	N 69°13'44" E	99.74'
L63	N 28°17'48" E	226.58'
L64	N 15°51'50" E	120.70'
L65	S 71°06'52" W	37.45'
L66	S 79°58'51" W	97.25'
L67	N 51°52'09" W	96.06'
L68	N 14°04'10" W	238.04'
L69	N 41°25'49" W	419.80'
L70	N 21°14'13" W	156.98'
L71	N 23°41'23" W	75.41'
L72	N 62°18'11" W	58.86'
L73	N 77°05'38" W	47.84'
L74	N 77°05'38" W	29.68'
L75	S 77°56'47" W	83.78'
L76	S 88°48'16" W	192.25'
L77	S 63°13'08" W	124.30'
L78	N 86°17'33" W	378.80'
L79	S 64°30'24" W	100.64'
L80	S 08°25'51" W	182.43'
L81	S 04°01'48" E	318.92'
L82	N 04°01'48" W	137.99'
L83	N 04°01'48" W	256.25'
L84	N 04°01'48" W	206.89'
L85	N 08°25'51" E	214.51'
L86	N 64°30'24" E	84.61'
L87	N 64°30'24" E	55.68'
L88	S 86°17'33" E	30.30'
L89	S 86°17'33" E	308.93'
L90	S 86°17'33" E	38.98'
L91	N 63°13'08" E	145.51'
L92	N 88°48'16" E	69.61'
L93	N 88°48'16" E	120.00'
L94	N 77°36'47" E	77.87'
L95	S 77°05'38" E	81.26'
L96	S 62°18'11" E	82.87'
L97	S 23°41'23" E	94.00'
L98	S 21°37'07" E	151.90'
L99	S 41°25'49" E	420.14'
L100	S 14°04'09" E	250.79'
L101	S 51°52'09" E	93.99'
L102	N 79°58'51" E	93.37'
L103	N 71°06'52" E	74.59'
L104	N 19°47'58" E	157.35'
L105	N 49°17'19" E	264.82'
L106	N 53°18'35" E	122.43'
L107	N 52°24'22" E	199.18'

L108	N 26°17'14" E	110.58'
L109	N 47°30'06" E	51.60'
L110	N 28°20'35" E	238.49'
L111	N 27°17'15" E	143.89'
L112	S 80°11'03" E	186.42'
L113	S 88°19'52" E	612.51'
L114	N 15°20'44" W	189.98'
L115	S 15°12'52" E	95.13'
L116	S 10°43'04" E	236.93'
L117	S 10°43'04" E	34.98'
L118	S 23°58'19" E	288.88'
L119	S 00°00'00" E	270.80'
L120	S 16°56'05" W	134.19'
L121	S 32°37'28" E	62.87'
L122	S 41°14'26" E	32.44'
L123	S 45°42'07" E	103.19'
L124	N 00°30'22" E	16.70'
L125	N 35°04'12" E	74.40'
L126	N 15°20'21" E	233.90'
L127	N 24°45'02" E	129.83'
L128	N 20°17'32" E	67.93'
L129	N 20°17'32" E	25.90'
L130	N 15°52'09" E	94.63'
L131	N 14°17'00" E	107.75'
L132	N 10°59'11" E	53.59'
L133	N 10°59'11" E	22.45'
L134	N 02°55'21" E	71.55'
L135	N 18°45'44" E	107.32'
L136	N 44°34'56" E	121.43'
L137	N 00°12'07" W	18.25'
L138	N 00°12'07" W	8.56'
L139	N 36°45'52" E	249.74'
L140	N 22°47'36" E	169.28'
L141	N 05°24'35" E	51.24'
L142	N 38°38'34" E	27.79'
L143	N 13°48'53" E	138.02'
L144	N 34°51'57" E	108.43'
L145	N 67°23'30" E	145.31'
L146	N 08°45'29" E	77.77'
L147	N 102°09' 76.60"	122.63'
L148	N 13°39'30" W	92.80'
L149	N 34°54'50" E	159.86'
L150	N 35°03'03" E	187.83'
L151	N 39°03'58" E	219.35'
L152	N 35°16'05" E	78.30'
L153	N 11°39'36" E	109.66'
L154	N 21°13'51" E	22.43'
L155	N 21°13'51" E	292.61'
L156	N 11°46'56" E	172.40'
L157	N 63°17'50" E	244.21'
L158	N 57°07'50" E	68.74'
L159	N 25°23'03" E	94.10'
L160	N 05°50'08" E	82.03'
L161	N 07°55'55" E	84.42'

CURVE	RADIUS	ARC LENGTH	CHORD BEARING	CHORD LENGTH
C1	991.80'	142.21'	N 68°33'51" W	142.09'
C2	267.16'	132.18'	N 47°47'17" W	130.83'
C3	129.59'	60.92'	N 34°24'24" W	60.36'
C4	155.88'	71.20'	N 49°18'20" W	70.58'
C5	149.87'	58.35'	N 78°50'44" W	57.99'
C6	395.44'	119.99'	N 79°50'44" W	119.53'
C7	20.00'	41.01'	S 49°01'02" W	34.20'
C8	15.00'	13.62'	S 17°23'26" E	13.16'
C9	50.00'	45.31'	S 17°26'29" E	43.77'
C10	50.00'	77.11'	S 52°41'53" W	69.69'
C11	50.00'	79.66'	S 37°28'50" W	71.50'
C12	50.00'	45.80'	N 34°24'02" E	44.21'
C13	15.00'	13.62'	N 34°37'46" E	13.16'
C14	77.31'	76.70'	N 53°14'54" W	73.60'
C15	64.11'	82.46'	S 60°23'21" W	76.89'
C16	710.98'	54.36'	S 18°58'52" W	54.34'
C17	15.00'	13.62'	S 78°47'30" W	13.16'
C18	50.00'	45.00'	S 78°33'55" W	43.50'
C19	50.00'	77.38'	N 31°18'59" W	69.88'
C20	50.00'	74.00'	N 55°24'55" E	67.43'
C21	50.00'	51.50'	S 52°40'59" E	49.25'
C22	15.00'	13.62'	S 48°11'17" E	13.16'
C23	20.00'	43.55'	N 46°30'39" W	35.44'
C24	95.88'	73.88'	N 77°56'46" W	72.06'
C25	89.90'	61.06'	N 32°24'42" W	59.89'
C26	52.09'	76.44'	S 68°24'44" W	69.76'
C27	90.89'	93.21'	S 46°17'52" W	89.17'
C28	52.09'	76.44'	S 68°24'44" W	69.76'
C29	90.89'	93.21'	S 46°17'52" W	89.17'
C30	383.67'	121.16'	N 78°28'19" E	120.66'
C31	25.00'	24.51'	S 27°30'02" E	23.54'
C32	50.00'	68.67'	N 11°15'06" E	63.40'
C33	50.00'	61.29'	N 63°12'45" E	57.53'
C34	50.00'	71.51'	S 40°41'44" E	65.27'
C35	50.00'	36.34'	S 21°06'01" W	35.95'
C36	25.00'	24.28'	N 20°41'57" E	23.18'
C37	443.45'	136.73'	N 78°24'07" E	136.19'
C38	40.89'	43.93'	N 43°56'44" E	41.85'
C39	102.09'	76.60'	N 44°43'50" E	74.81'
C40	102.09'	74.96'	N 87°15'32" E	73.29'
C41	39.90'	27.49'	S 32°07'56" E	26.95'
C42	45.88'	33.92'	S 78°50'20" E	33.16'
C43	64.65'	58.74'	N 46°45'40" E	56.74'
C44	660.98'	50.39'	N 18°45'37" E	50.37'
C45	114.11'	151.48'	N 59°51'10" E	140.60'
C46	128.77'	86.90'	S 63°41'48" E	85.26'
C47	132.32'	47.39'	N 33°10'51" W	47.13'
C48	20.00'	31.13'	S 27°38'58" E	28.08'
C49	392.71'	135.06'	S 78°03'47" E	134.39'
C50	199.87'	80.52'	S 78°19'21" E	79.98'
C51	218.95'	88.47'	S 50°47'44" E	87.89'
C52	161.10'	74.17'	S 35°37'46" E	73.51'
C53	217.16'	104.35'	S 47°22'50" E	103.35'
C54	845.72'	118.61'	S 68°09'25" E	118.51'

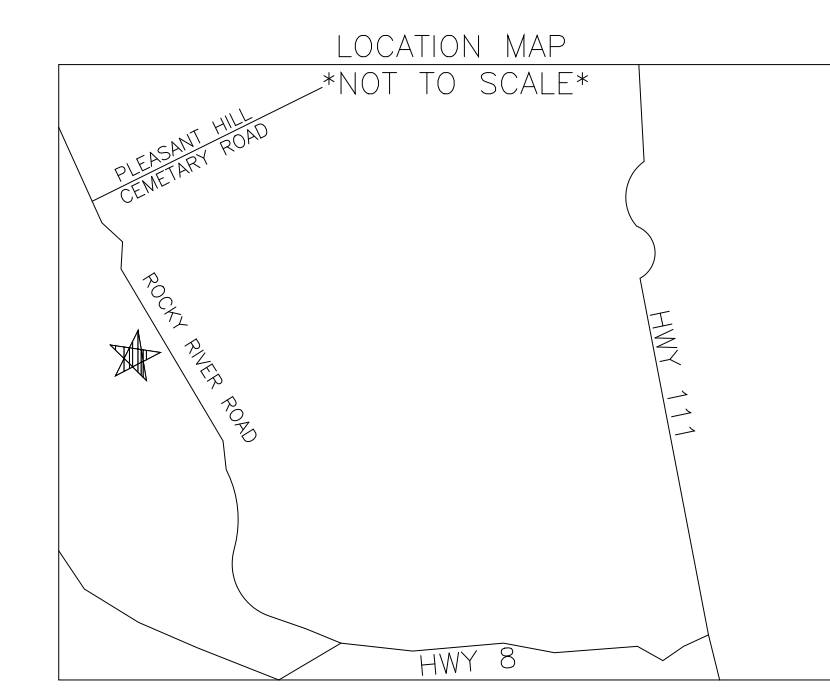

FINAL PLAT FOR
WHISPERING PINES EQUESTRIAN ESTATES
PHASE 2
JOHN ASHLEY

DEVELOPER: JOHN ASHLEY ADDRESS: 5279 WEST ANGELA DRIVE GLENDALE, AZ 85308 TELEPHONE: 602-614-0400	SURVEYOR: CHRISTOPHER M. VICK ADDRESS: 2772 HIDDEN COVE ROAD COOKEVILLE, TN. 38506 TELEPHONE: 931-372-1286
ENGINEER: ADDRESS: TELEPHONE:	ACREAGE SUBDIVIDED: 266.48 LOTS: 39 SCALE: 1"=300'-0" DATE: 10 Feb. 2006 TAX MAP REFERENCE: Map84 Parcel6.02 DEED BOOK REFERENCE: Book 20 Pg 214

REVISED: 28 FEBRUARY 2007

Note: A 1/2" pipe (set) is common on all corners unless otherwise noted.

Note: Included within the above drawn lots is a 20' private/public utility easement extending beyond the existing road right-of-ways.

Note: This property may be subject to utility ingress/egress and/or right-of-ways.

I hereby certify that this is a category II survey and that the ratio of precision of the unadjusted survey is 1:7500 as shown hereon.

Drawn by: MLJ